



PRODUCT DATASHEET KELVIN

SINGLE-USE CELLULAR CONNECTED TEMPERATURE DATALOGGER WITH LCD DISPLAY KELVIN S100



End-to-end visibility of your temperature sensitive assets in real-time.

Logistics of critical and sensitive consignments is a multi-stage process including loading, unloading and storing in different places. Kelvin Cellular-Connected Datalogger is built with multiple sensors to make every blind spot and manual intervention visible, especially while monitoring air cargo.



Temperature Monitoring



Real time location tracking



Waterproof and Food Grade Packing



High-Precision Digital Sensor



LCD Display for Temperature Reading



Cost Effective and Reliable



Flight Mode (IATA, FAA)



Geofencing

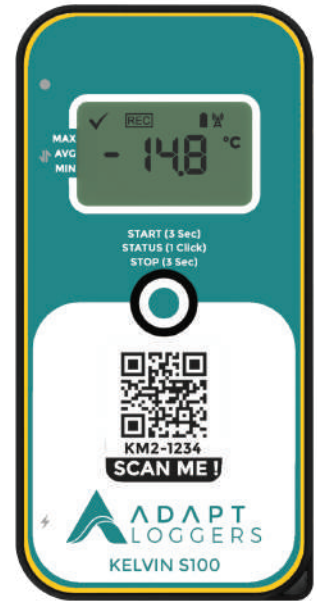

Product Anatomy

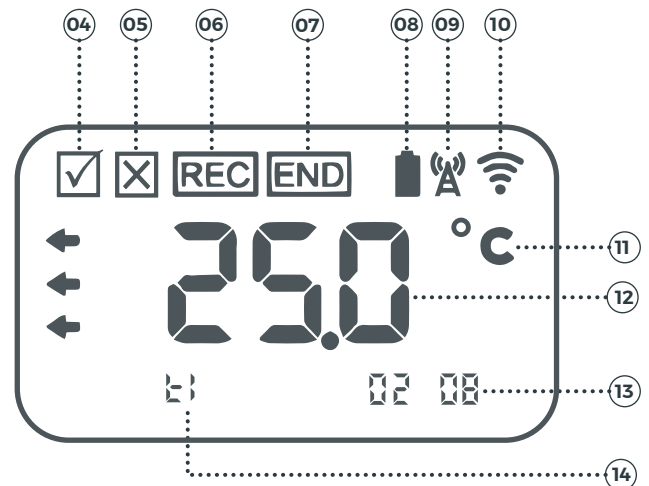
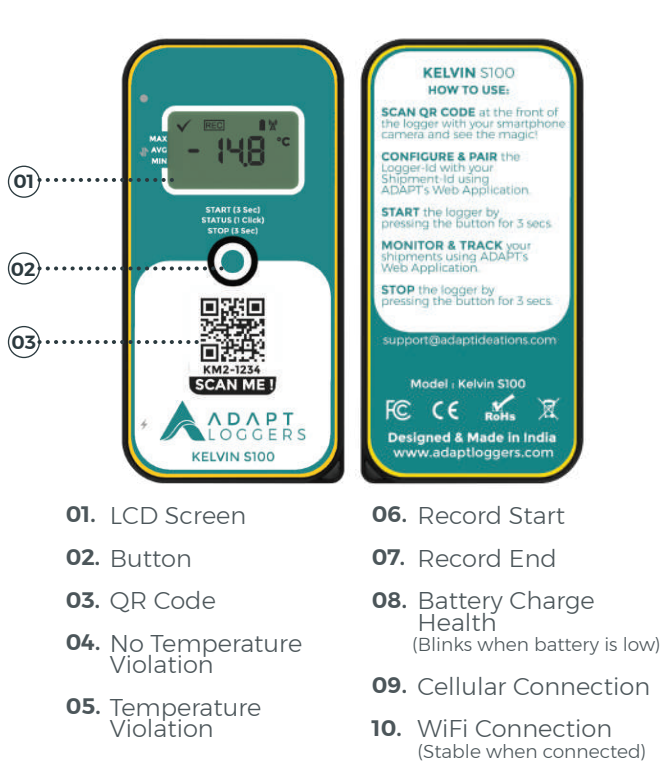

Visit us at www.adaptloggers.com

For further queries, please drop a mail to info@adaptideations.com or call us at +91-4045207973 **01**

SINGLE-USE CELLULAR CONNECTED TEMPERATURE DATALOGGER WITH LCD DISPLAY

KELVIN S100



Easy to use

CONFIGURE

Configure the datalogger according to your requirement using ADAPT's platform.



PAIR

Add the device to a shipment.



TRACK

Track the shipment on our platform

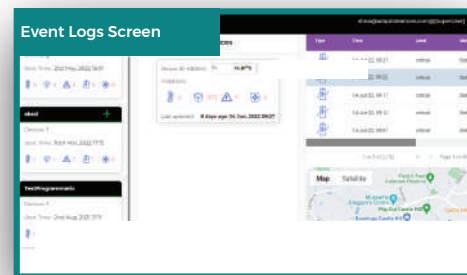
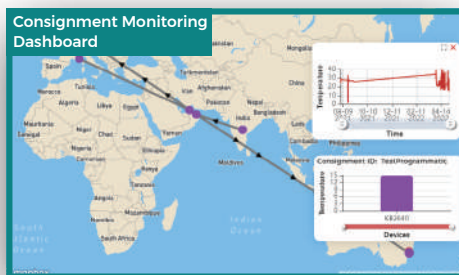

Technical Specifications

Dimensions (L x W x H): 105mm x 50mm x 18.5mm

Weight: 140g

Battery: Li-ion, 3000mAh

Runtime (Maximum Trip Duration) 30 days @30 mins sending interval (@room temperature)

Reading Interval: 5 min (configurable)

Reading Transmission: 30 min (configurable)

WiFi: 2.4 GHz

Cellular: 2G/4G(CAT M1), Sim inbuilt

Temperature Sensor Type: Digital

Temperature Range: -20° C to +60° C

Temperature Accuracy: +/-0.5°C

Temperature Calibration: Factory Calibrated

Probe Support No

Standards: FCC/CE Compliance

Water Resistance: IP64

Compliance: FAA:AC 91.21 -1D, 2017, p. 91
EU: AMC1 CAT.GEN.MPA.140
As per the guidelines of IATA on Portable Electronics Devices (PEDs) Airline Approved

Violations: Violations are logged as events on web-portal and device

Notifications: SMS, Email, Push

Data formats and graphs: Graphs, PDFs, CSVs (downloadable from portal)

Data storage on Device: 9000 readings (30 days @ 5 mins interval)

Scan to know more about KELVIN S100
Single-use Cellular-connected temperature datalogger



Designed, developed and manufactured in India.

For further queries, please drop a mail to info@adaptideations.com or call us at +91-4045207973 **02**